

PLAF BRIEFING NOTE

17 December 2012 – Agenda Item 9 – SWCP Update



1. Introduction

- 1.1 This report provides the Forum with an update on matters relating to the South West Coast Path.

2. Royal William Yard Coast Path Link

- 2.1 Plymouth City Council has been awarded a grant of £237,000 by Natural England to re-route the South West Coast Path (SWCP) through Devil's Point Park to connect this area to the nationally important Grade I Listed Royal William Yard (RWY). Delivering the important link between RWY and the Park will involve constructing a stairway into the Yard that will enable the SWCP to be connected all the way around the peninsula on which the Park and the RWY are situated. Providing this complete route around the peninsula will deliver a long held aspiration to connect these two popular features, enable communities to be directly linked to the attractions within RWY and enable greater use of the Park.

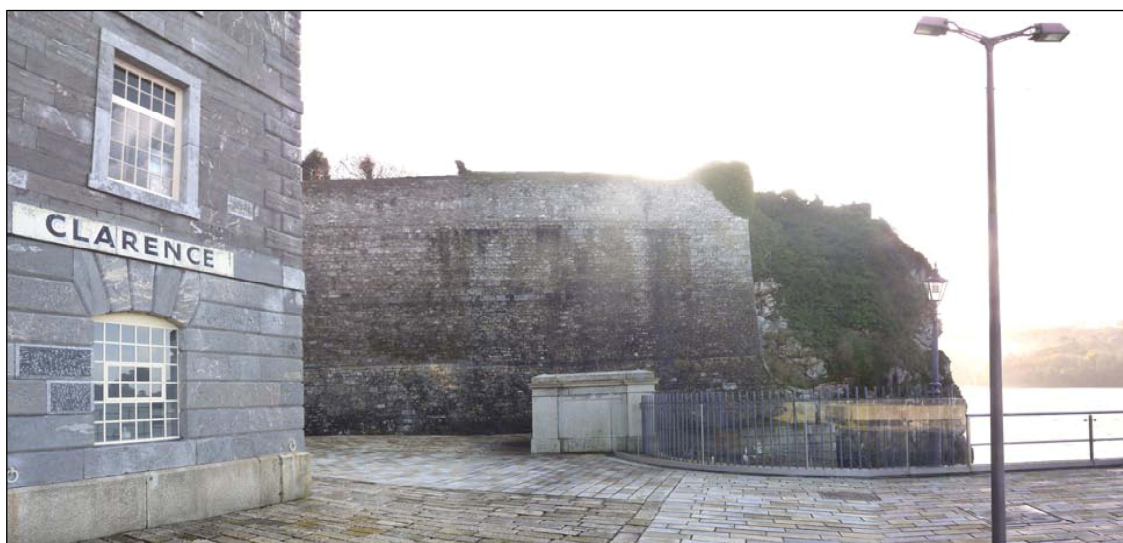

- 2.2 Constructing the staircase and re-routing the SWCP around the headland will enable better use of the outstanding natural and historical assets of both the Park and the Yard and promote the economic and cultural vitality of the area. It will also provide a stunning new visitor attraction for the SWCP that will enhance the visitor experience within this part of Plymouth. The multiple benefits that would result from the delivery of the project are the reason that Natural England have offered to fund the works as part of their role to improve and promote a network of National Trails.
- 2.3 The total cost of delivering the new coast path link is £250k. The £237k offered by Natural England will be met by additional funding provided by the SWCP Association (£10k) and the Friends of Devils Point Park (£3K). The Council has also put forward £15k towards improvements to Devils Point Park itself.

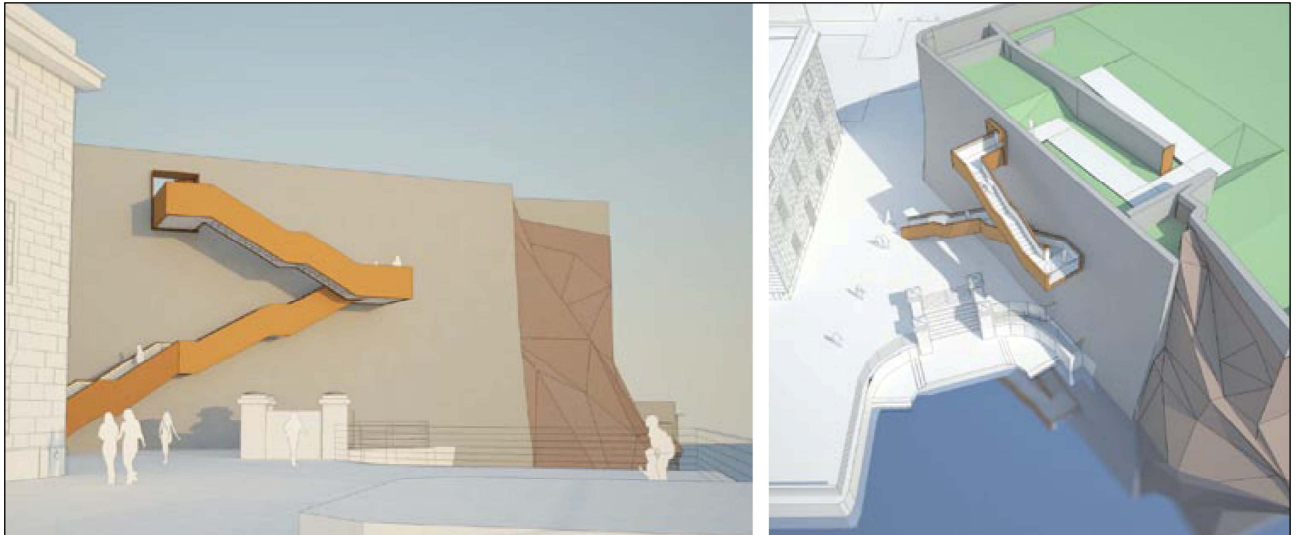

- 2.4 Planning Permission has already be granted for the steps which Urban Splash will be implementing. A condition of the grant is that the work is completed in the 2012/13 financial year.

3. SWCPA 40th Anniversary Walk

- 3.1 The South West Coast Path Association is organising a fundraising event to mark their 40th anniversary next Spring. Their aim is to raise funds for small but significant improvement projects, over and above general maintenance of the path.
- 3.2 The event, which takes place next April/May, encompasses a series of walks along the coast path which has been broken down into 56 legs and will be done in relay to cover the entire 630 mile path. This will culminate with both relays meeting at Land's End on 7th May 2013 where a birthday party will take place. The walks start at Poole on 3rd April, with the North coast relay starting at Minehead on 16th April. Each leg will be guided by local experts, rangers and path wardens, who are all assisting the SWCPA with this event.
- 3.3 Walkers will be asked to raise a minimum sponsorship of £50 each which will be combined with grants, corporate sponsorship and match funding and it is expected that £250,000 will be raised. This money will be spent on a series of improvement projects which will be spread along the route of the entire path. These projects have all been selected to enhance the experience and enjoyment of walkers using the path and walkers taking part will be able to allocate their sponsorship towards their favorite projects.
- 3.4 The walk through Plymouth will take place on Sunday 21 April 2013 and will encompass the 9.5 miles between Jennycliff and Admirals Hard. The walk is split into a 6 mile section between Jennycliff and the Barbican in the morning and a further 3.5 mile section from the Barbican to Admirals Hard in the afternoon.
- 3.5 All participants are required to register for each walk by filling in a registration form and sending it to the SWCPA with their registration fee of £10 per person. Registration can also be completed online with registration fee paid by a credit card via the website at www.greatsouthwestwalk.co.uk. The registration fee covers the cost of a T shirt that each participant will hopefully wear, insurance and also the cost of transport to take the participants from the meeting point outside the Royal William Yard, Stonehouse to the actual walk start point. LAF Members who wish to support this event can find sponsor forms available for download from the website above by following links on the site to the fund raising page.